

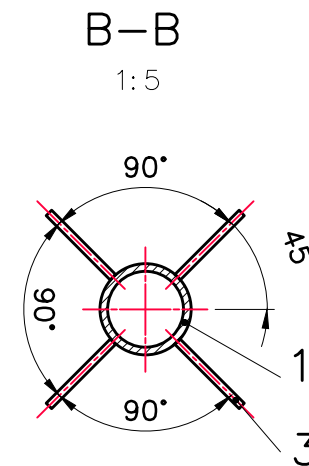

ACEST DOCUMENT ESTE PROPRIETATEA SOCIETATII ELLIS'92 S.R.L.-PLOIESTI. IN CONSECINTA, FIRMA ARE DREPTUL  
EXCLUSIV DE FOLOSIRE A DESENULUI SAU DE OPERARE A EVENTUALELOR MODIFICARI DIN CAMPIUL ACESTUIA.

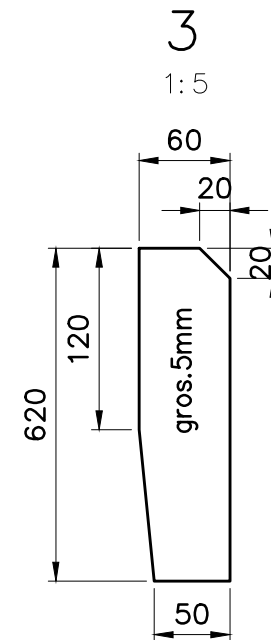
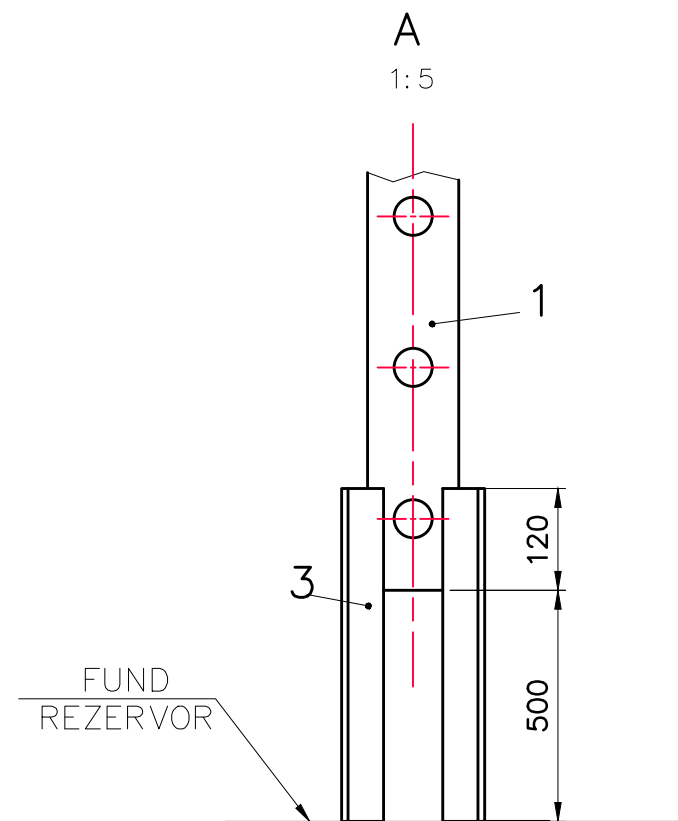
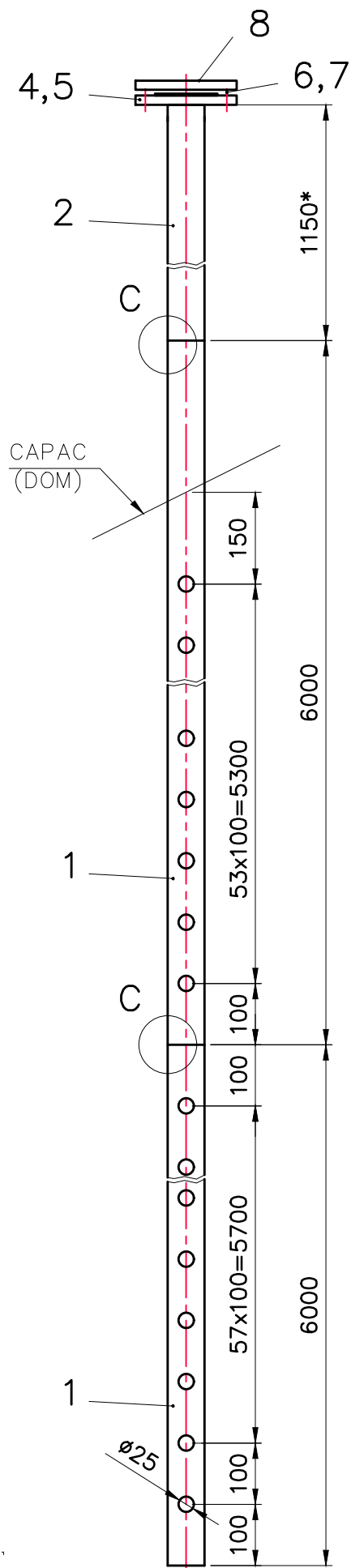
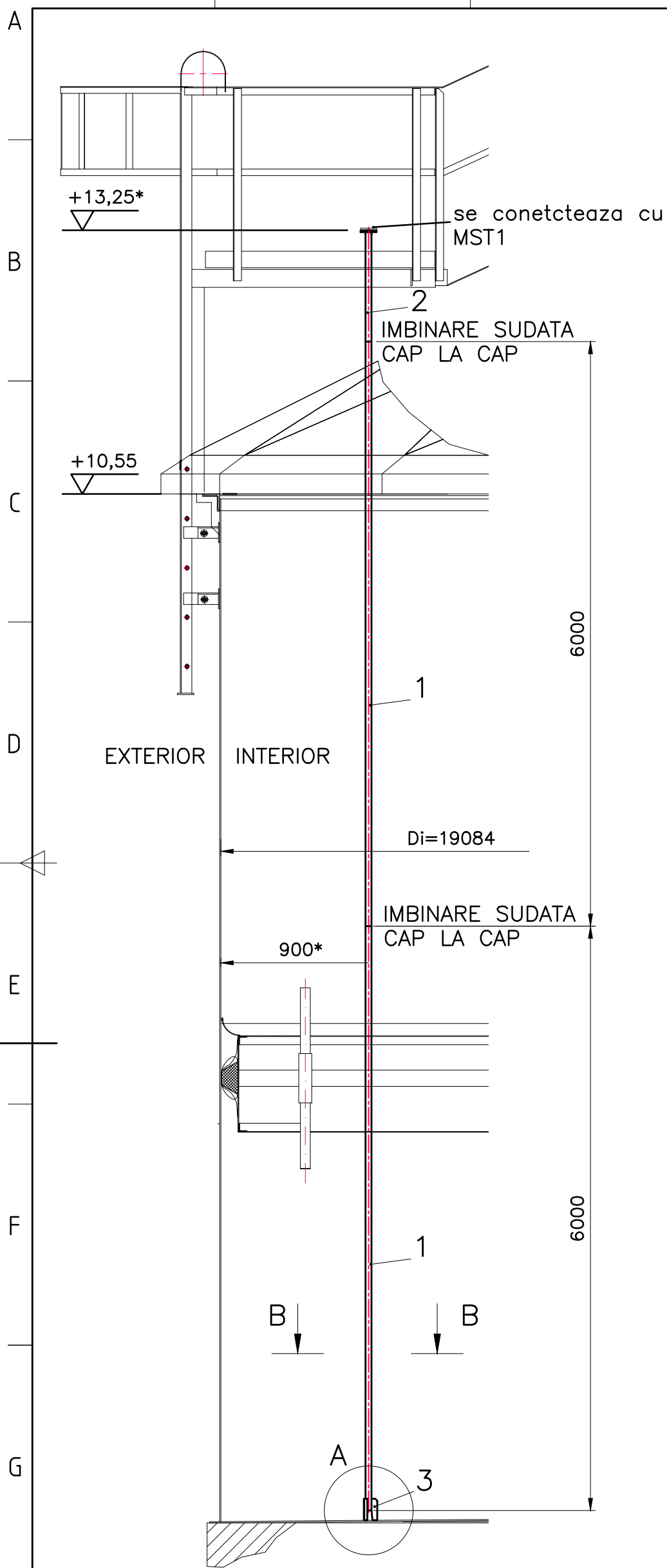

#### NOTA

1. Pentru pozitia racordului pe dom, vezi desen A656U-00
2. Cota notata cu (\*) se coreleaza cu fisa domului, va fi minim 800mm

8	Flansa racordare DN50, tip 11B, PN16		1	P280GH SR EN 10222-2		3.3	
7	Piulita stil 2 M16	SR EN 1515-4:2010	8	C35E SR EN 10269:2014		0,0308	
6	Prezon M16x100, tip1B	SR EN 4033:2007	4	C45E SR EN 10269:2014	filet pe toata lungimea	1,58	
5	Garnitura tip IBC		1	cauciuc+ins.met.		0.082	
4	Flansa racordare DN50, tip 11B, PN16		1	P280GH SR EN 10222-2		3,06	
3	Distantier		4	S235J2 SR EN 10025-2:2004	Tb.620x60x5	3,52	
2	Element stalp 2		1	S235J2 SR EN 10025-2:2004	Tv.ø60,3x5-1100	7,50	
1	Element stalp 1		2	S235J2 SR EN 10025-2:2004	Tv.ø60,3x5-6000	41,00	
	Electrozi	SR EN ISO 2560:2010	-			3,04	
Poz.	Denumirea	Nr.desen sau STAS	Buc	Material	Observatii	Masa kg/buc	
3			6				
2			5				
1			4				
Rev.	Descriere	Data	Semnat	Rev.	Descriere	Data	Semnat
Acest document este proprietatea S.C. ELLIS'92 S.R.L. si nu va fi comunicat fara autorizare							
Intocmit	Verificat	Aprobat	Beneficiar		Denumire proiect		
S.B.	N.R.	A.I.	CONPET SA		CONSTRUCTIE REZERVOR NOU PENTRU TITEL (V=2500 mc) STATIA DE POMPARE BILED TIMS		
			STALP TEMPERATURA MST1		Nr.: A642U-12.00		
			-R12-		Scara:1: 100		
Material:			Masa:116,32Kg		Data: 04.2019	Rev.0	
					Plansa: 1/1		